



MOS Controlled Diode

PRODUCT SUMMARY

V _{RRM}	I _O	V _F (MAX) @ 25°C	I _R (MAX) @ 25°C
50V	25A	0.56V	0.5mA

FEATURES

- Low Profile Design for Smart Phone Charger
- Ideal for SMT Mounting
- Low forward voltage drop
- High forward surge capability
- Excellent High Temperature Stability



ABSOLUTE MAXIMUM RATINGS (T_A=25°C unless otherwise noted)

Symbol	Parameter	Value	Unit
V _{RRM}	Peak Repetitive Reverse Voltage	50	V
V _{RWM}	Working Peak Reverse Voltage	50	V
V _{RM}	DC Blocking Voltage	50	V
V _R (RMS)	RMS Reverse Voltage	35	V
I _O	Average Rectified Output Current	25	A
I _{FSM}	Non-Repetitive Peak Forward Surge Current 8.3ms Single Half Sine-Wave Superimposed on Rated Load	300	A
E _{AS}	Non-Repetitive Avalanche Energy (T _J = 25°C, I _{AS} = 15, L = 5mH)	410	mJ
P _{ARM}	Repetitive Peak Avalanche Energy	36000	W

THERMAL CHARACTERISTICS

Symbol	Parameter	Value	Unit
R _{θJA}	Thermal Resistance, Junction-to-Ambient	12	°C/W
T _J	Operating Temperature Range	-55 to 150	°C
T _{STG}	Storage Temperature Range	-55 to 175	°C

ELECTRICAL CHARACTERISTICS (T_A=25°C unless otherwise specified)

Symbol	Parameter	Conditions	Min	Typ	Max	Unit
V _F	Forward Voltage Drop	I _F = 20A, T _J = 25°C		0.48	0.52	V
		I _F = 25A, T _J = 25°C		0.52	0.56	V
		I _F = 25A, T _J = 125°C		0.51	0.55	V
I _R	Leakage Current	V _R = 50V, T _J = 25°C		180	500	uA
		V _R = 50V, T _J = 125°C			100	mA
C _T	Total Capacitance	V _R = 50V, f = 1MHz		290		pF

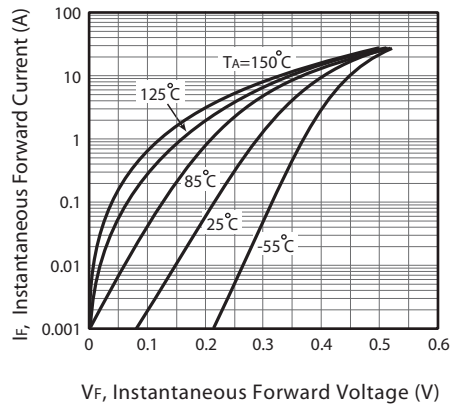

Figure 1. Typical Forward Characteristics

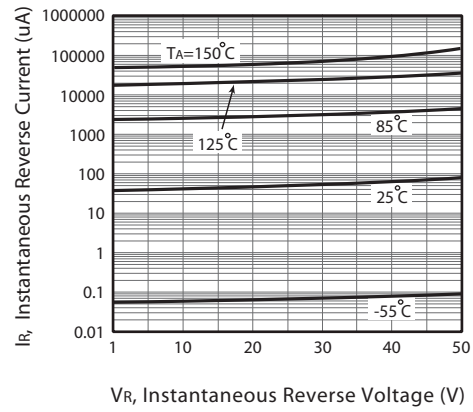

Figure 2. Typical Reverse Characteristics

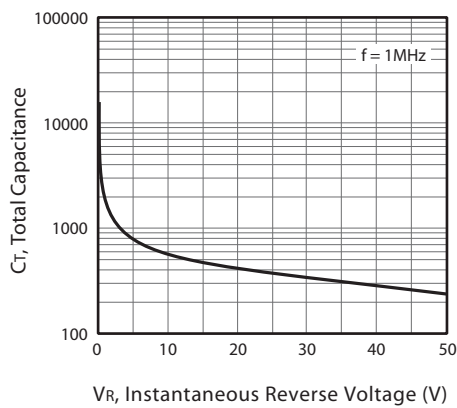

Figure 3. Total Capacitance vs. Reverse Voltage

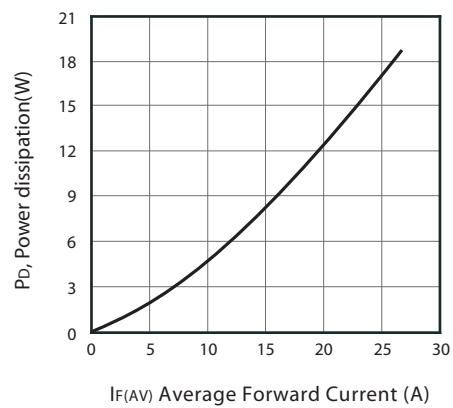

Figure 4. Forward Power Dissipation

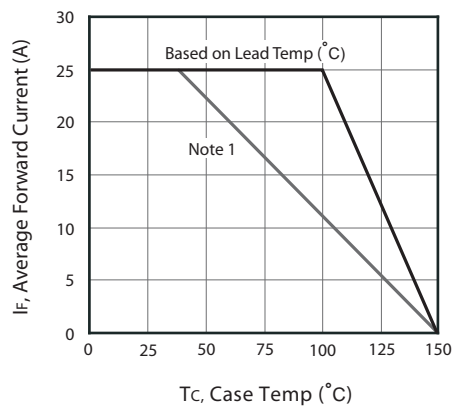

Figure 5. Forward Current Derating Curve

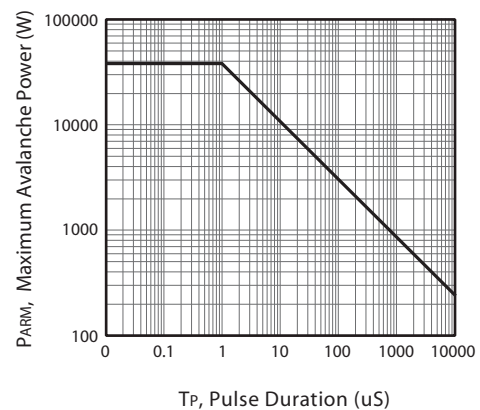

Figure 6. Maximum Avalanche Power Curve

Note: 1. Device mounted on FR-4 substrate, 2oz copper, with 10cm x 10cm pad layout.

SMD25U50P

Ver 1.0

PACKAGE OUTLINE DIMENSIONS

DFN 5x6

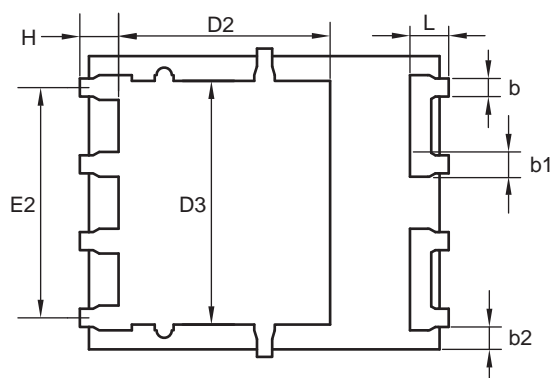
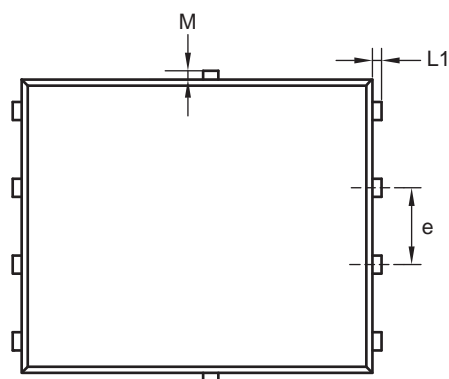

SYMBOLS	MILLIMETERS		
	MIN.	NOM.	MAX.
A	0.90	1.00	1.10
b	0.20	0.30	0.40
b1	0.31	0.41	0.51
b2	0.25	0.35	0.45
C	0.15	0.25	0.35
D	5.90	6.10	6.30
D1	5.60	5.80	6.00
D2	3.50 REF.		
D3	4.00 REF.		
E	5.00	5.20	5.40
E1	4.70	4.90	5.10
E2	3.71	3.81	3.91
e	1.17	1.27	1.37
H	0.63 REF.		
L	0.53	0.63	0.73
L1	0.05	0.15	0.25
M	0.05	0.15	0.25
θ	8°	10°	12°

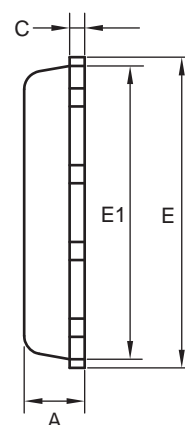
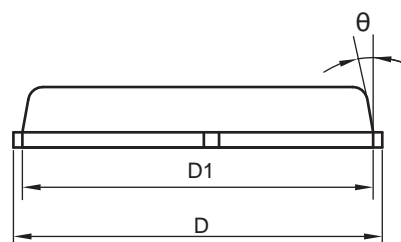

Dec,01,2014

SMD25U50P

Ver 1.0

TOP MARKING DEFINITION

DFN 5x6

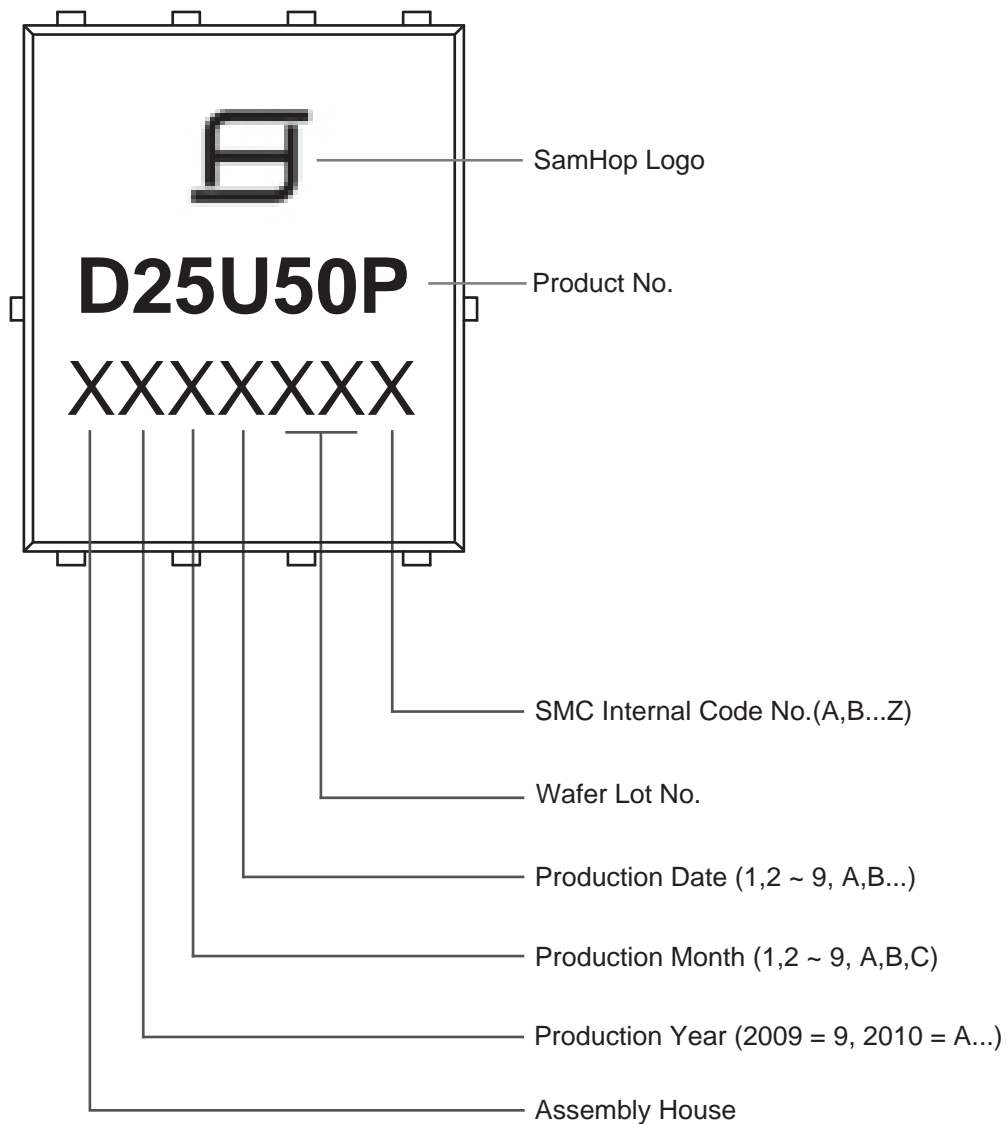

Dec,01,2014